

For Lease

Great Neck, NY

62 Middle Neck Road



Retail space in the heart of Great Neck | FOR LEASE

ADDRESS

62 Middle Neck Road, Great Neck, NY

AVAILABLE

1,200 square feet plus additional full basement

ASKING RENT

Upon Request

EXTRAS

Upon request

AREA RETAIL

TD Bank, Starbucks, Wells Fargo, Planet Fitness, Chipotle, Rite Aid, Bareburger, Peter Luger Steakhouse, H Mart, Dollar Tree, USPS, Inn at Great Neck, Bank of America, Il Bacco, and many more

Demographics	1 mile	3 miles	5 miles
Population	23,866	138,120	526,963
Median HHI	\$125,402	\$117,896	\$105,415
Daytime Population	24,479	91,222	203,884

CO-TENANTS

Gino's Pizza of Great Neck, Salon Ruby, Shoshaku, Lazar's Chocolate, Rothchild's Coffee & Kitchen

- Basement space available
- Located on Middle Neck Road which sees 25,446 vehicles per day



For Lease

Great Neck, NY

62 Middle Neck Road

PROPOSED FIRST FLOOR POWER PLAN

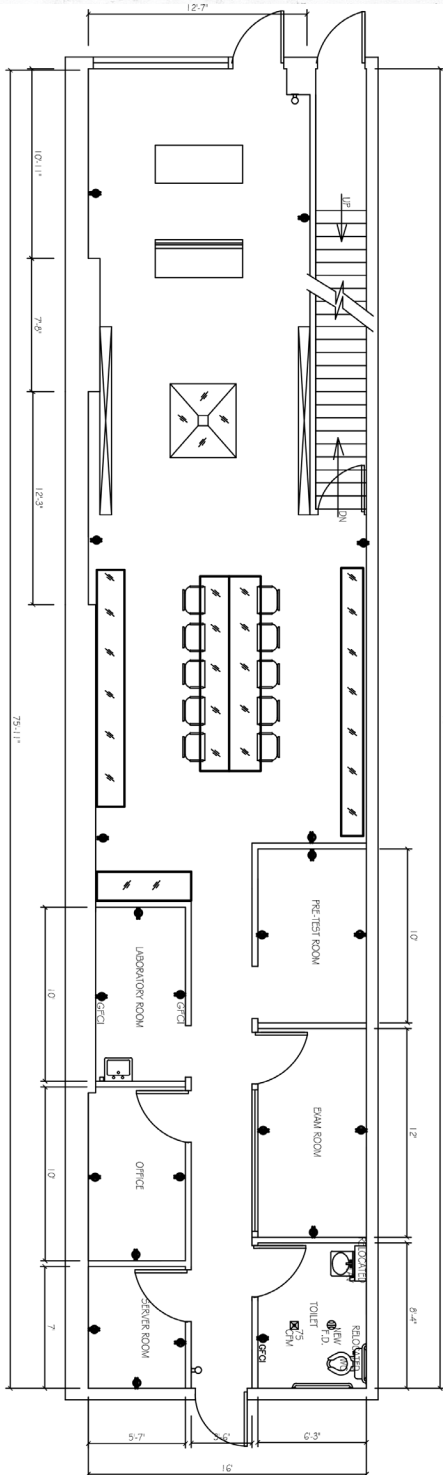

LEGEND:

- EXIST. WALL OR PARTITION TO REMAIN
- NEW PARTITION
3 5/8" 25 GA. METAL STUDS @ 16"O.C. W/ ONE LAYER OF 5/8" GYPSUM BOARD ON EACH SIDE.
- NEW WINDOW
- EXIST. 2'X4' LAY-IN FLUORESCENT LIGHT FIXTURE
- NEW PENDENT LIGHT
- NEW RECESSED LIGHTING FIXTURE
- EXIT SIGN & EMERGENCY LIGHT WITH BATTERY PACK WIRE TO LOCAL LIGHTING CIRCUIT
- EMERGENCY LIGHT WITH BATTERY PACK WIRE TO LOCAL LIGHTING CIRCUIT
- ABC PORTABLE EXTINGUISHER, 10LB. @ 48" A.F.F. MAX.
- SWITCH
- 20A, 120V CONVICIENCE RECEPTACLE MOUNT AT 18" AFF UNLESS CIRCUIT



For Lease

Bridgewater, NJ

1213 Route 22 West



SABRE

William Diakakis
diakakis@sabre.life | T 516 874 8070 x 1521

SABRE Real Estate Group, LLC | 500 Old Country Road Garden City NY 11530

sabre.life

© SABRE Real Estate Group, LLC. This information has been obtained from sources believed reliable. We have not verified it and make no guarantee, warranty or representation about it. Any projections, opinions, assumptions or estimates used are for example only and do not represent the current or future performance of the property. You and your advisors should conduct a careful, independent investigation of the property to determine to your satisfaction the suitability of the property for your needs.